



# WALKER RANGE

Mini 6 | XL | Flex 6 & 8 | Deluxe | Tri-Wheel | Classic 6 | Classic 8

## USER MANUAL



MINI 6"



XL



FLEX 6" & 8"



DELUXE



TRI-WHEEL



CLASSIC 6"



CLASSIC 8"

# TABLE OF CONTENTS

1. Intended Use	4
2. Symbols Used In This Manual	4
3. Symbols Used On The Product	5
4. Limitations For Use	5
5. Warnings	6
6. Product Specifications	7
7. Product Description	8
8. Instructions For Use	12
9. Care, Maintenance & Customisation	20
10. Compliance	21
11. Warranty	21
12. Service Log Book	22

Thank you for choosing this Aspire walker.

This product has been specifically designed to offer comfort, support and safety. Aspire seat walkers are suitable for indoor and outdoor use and are available in a range of sizes.

**It is important that you read this user manual carefully before using your new walker.**



This product Features the UKCA mark, in compliance with Part II UK MDR 2002 (as amended) Class 1.

## 1. INTENDED USE

Aspire walkers are specifically designed for individuals who, due to a wide variety of reasons, require additional support while walking. It should be used as a tool to assist people who have mobility difficulties with standing, walking or sitting independently.

This walker is designed for indoor and limited outdoor use. When used outdoors this walker must remain on sealed, level terrain (examples include but are not limited to shopping centres, medical centres, flat and level footpaths, and environments with accessibility-focused layouts. Any other usage outside of the intended use is not advised

## 2. SYMBOLS USED IN THIS MANUAL

The symbols below are used throughout this user manual and on the product to identify warnings and important information. It is very important for you to read them and understand them completely



**WARNING**

**WARNING!** Indicates a potentially hazardous condition/ situation. Failure to follow designated procedures can cause either personal injury, component damage or malfunction. On the product, this icon is represented as a black symbol on a white triangle with a black border.



**ALWAYS!** These actions should be performed as specified. Failure to perform mandatory actions can cause personal injury and/or equipment damage. On the product, this icon is represented as a white infinity symbol on a black dot with a white border.



**DO NOT!** These actions are prohibited. These actions should not be performed at any time or in any circumstances. Performing a prohibited action can cause personal injury and/or equipment damage. On the product, this icon is represented as a white symbol with a black circle and black slash.

## 3. SYMBOLS USED ON THE PRODUCT



#	Product Code	SWL xxxKG	Safe Working Load
SN	Serial Number	Book icon	Read User Manual
Factory icon	Manufacturer	Warning triangle	Caution
Globe icon	Importer	MD	Medical Device
Factory icon with CN	Country of Manufacture	UK REP	Authorised Representative in UK
UK CA	UKCA Mark		

## 4. LIMITATIONS FOR USE

### SEAT WALKER SAFE WORKING LOAD (SWL)

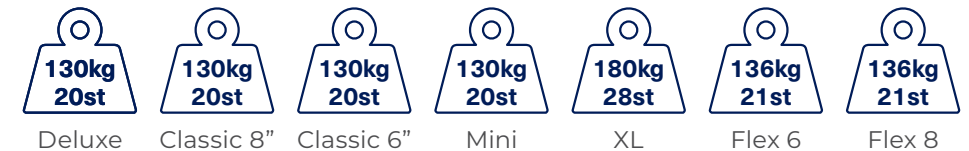

## 5. WARNINGS



WARNING

**WARNING!** This User Manual must be read before using the walker. The manufacturer does not take any responsibility for damage and/or injuries caused by the fact that the User Manual has not been followed.



WARNING

**WARNING!** The walker must not be used by users with serious difficulty balancing or whose muscle strength is too low to stand and walk, even with the extra support of a walker.



WARNING

**WARNING!** The decision to use a walker should always be guided by a qualified Health Care Professional, who can also advise and assist with the correct height adjustment and usage instruction.



WARNING

**WARNING! Sloped, slippery, or uneven terrain**  
This walker is designed to be used on a flat-level surface. If encountering sloped, slippery, or uneven terrain an alternative route to be sought.



**NOTE:** Fingers or other body parts can be trapped between the walker's parts during folding, unfolding or adjusting of the walker. Be extremely careful when adjusting the walker. Observe the dimensions of gaps between the walker's elements to avoid trapping your fingers or other body parts.

**DO NOT** exceed safe working load 130kg (180kg for XL model, 135kg for Stride, 130kg for Mobiflex, 136kg for Flex model)

Ensure that your seat walker is opened fully (folding hinge is straight) before using it

**DO NOT** stand on this product

**DO NOT** position the rollator near sources of heat such as prolonged direct sunlight, fireplaces, heaters etc. The metal frame will absorb heat and may become hot to touch.

Ensure both push handles are adjusted to the same height

Seek advice from a trained health care professional or approved Aspire retailer representative for height adjustment of this product

Prior to every use brakes need to be checked to ensure they are in working condition. **DO NOT** use the walker if the brakes are not functioning correctly

**DO NOT** use in place of a wheelchair or patient transport device

**DO NOT** modify this walker

**DO NOT** attempt to replace the wheels or castors of your seat walker. If they are faulty or require replacement please contact an authorised repairer

## 6. PRODUCT SPECIFICATIONS

Overall Height	Overall Length	Overall Width	Seat Depth	Seat Width	Seat Height	Backrest Height	Folded Width	Castor Size	Unit Weight	SWL
mm / inches	mm / inches	mm / inches	mm / inches	mm / inches	mm / inches	mm / inches	mm / inches	inches	kg / lb	kg / stone



### Seat Walker Deluxe

834-989 / 32.8-38.9	764 / 30.1	545 / 21.5	305 / 12	355 / 14	587 / 23.1	836 / 32.9	245 / 9.6	8	7 / 15.4	130 / 20
---------------------	------------	------------	----------	----------	------------	------------	-----------	---	----------	----------

### Seat Walker Classic 6"

760-915 / 29.9-36	624 / 24.6	615 / 24.2	305 / 12	355 / 14	528 / 20.8	769 / 30.3	200 / 7.9	6	7 / 15.4	130 / 20
-------------------	------------	------------	----------	----------	------------	------------	-----------	---	----------	----------

### Seat Walker Classic 8"

817-972 / 32.1-38.2	660 / 26	628 / 24.7	305 / 12	355 / 14	584 / 23	815 / 32.1	200 / 7.9	8	7 / 15.4	130 / 20
---------------------	----------	------------	----------	----------	----------	------------	-----------	---	----------	----------

### Seat Walker Mini

743-905 / 29.2-35.6	556 / 21.9	615 / 24.2	305 / 12	355 / 14	490 / 19.3	690 / 27.2	200 / 7.9	6	7 / 15.4	130 / 20
---------------------	------------	------------	----------	----------	------------	------------	-----------	---	----------	----------

### Seat Walker XL

875-685 / 26.9-34.4	710 / 28	740 / 29.1	340 / 13.4	495 / 19.5	555 / 21.9	850 / 33.5	230 / 9.1	8	7 / 15.4	180 / 28
---------------------	----------	------------	------------	------------	------------	------------	-----------	---	----------	----------

### Walker Tri-Wheel

825-925 / 32.5-36.4	575 / 22.6	715 / 28.1	-	-	-	-	275 / 10.8	8	5.5 / 12.1	115 / 18.1
---------------------	------------	------------	---	---	---	---	------------	---	------------	------------

### Seat Walker Flex 6"

730-830 / 28.7-32.6	730 / 28.7	570 / 22.4	300 / 11.8	360 / 14.1	430-520 / 16.9-20.4	710 / 27.9	290 / 11.4	6	6.3 / 13.8	136 / 21
---------------------	------------	------------	------------	------------	---------------------	------------	------------	---	------------	----------

### Seat Walker Flex 8"

780-970 / 30.7-38.1	820 / 32.2	585 / 23	300 / 11.8	360 / 14.1	475-570 / 18.7-22.4	760 / 29.2	390 / 15.3	8	7.3 / 16	136 / 21
---------------------	------------	----------	------------	------------	---------------------	------------	------------	---	----------	----------

## 7. PRODUCT DESCRIPTION



### SEAT WALKER DELUXE



Rustproof, robust aluminium frame for durability and stability, very light to manoeuvre and transport

Inline rear castors for increased stepping zone

Handle height adjusts quickly with hand wheels for optimal sizing

Anatomically designed, latex-free handles allow comfortable grip especially for users with arthritis

Ultra-soft hand brakes with palm ball lock effortlessly, offering increased comfort for users with arthritis or wrist/hand joint pain

Padded seat flips up easily for access to storage bag (supplied) or for folding

Curved and padded backrest offers comfortable seated support and flips up/removes easily for folding/storage

Easy folding mechanism facilitates storage and transportation

Swivelling front castor wheels increase manoeuvrability

8" solid, puncture-proof wheels which provide increased manoeuvrability over various surfaces

Available in blue or red

Easy wipe-clean surfaces



### SEAT WALKER CLASSIC 8"



Rustproof, robust aluminium frame for durability and stability, very light to manoeuvre and transport

Handle height adjusts quickly with hand wheels for optimal sizing

Anatomically designed, latex-free handles allow comfortable grip especially for users with arthritis

Ultra-soft hand brakes with palm ball lock effortlessly, offering increased comfort for users with arthritis or wrist/hand joint pain

Padded seat flips up easily for access to storage bag (supplied) or for folding

Curved and padded backrest offers comfortable seated support and flips up/removes easily for folding/storage

Easy folding mechanism facilitates storage and transportation

Swivelling front castor wheels increase manoeuvrability

8" solid, puncture-proof wheels which provide increased manoeuvrability over various surfaces

Available in blue or red

Easy wipe-clean surfaces



### SEAT WALKER CLASSIC 6"



Rustproof, robust aluminium frame for durability and stability, very light to manoeuvre and transport

Handle height adjusts quickly with hand wheels for optimal sizing

Anatomically designed, latex-free handles allow comfortable grip especially for users with arthritis

Ultra-soft hand brakes with palm ball lock effortlessly, offering increased comfort for users with arthritis or wrist/hand joint pain

Padded seat flips up easily for access to storage bag (supplied) or for folding

Curved and padded backrest offers comfortable seated support and flips up/removes easily for folding/storage

Easy folding mechanism facilitates storage and transportation

Swivelling front castor wheels increase manoeuvrability

6" solid, puncture-proof wheels provide increased manoeuvrability over various surfaces

Available in blue or red

Easy wipe-clean surfaces



### SEAT WALKER MINI



Rustproof, robust aluminium frame for durability and stability, very light to manoeuvre and transport

Low 490mm seat height to suit lower height/shorter users

Handle height adjusts quickly with hand wheels for optimal sizing

Anatomically designed, latex-free handles allow comfortable grip especially for users with arthritis

Ultra-soft hand brakes with palm ball lock effortlessly, offering increased comfort for users with arthritis or wrist/hand joint pain

Padded seat flips up easily for access to storage bag (supplied) or for folding

Curved and padded backrest offers comfortable seated support and flips up/removes easily for folding/storage

Easy folding mechanism facilitates storage and transportation

Swivelling front castor wheels increase manoeuvrability

6" solid, puncture-proof wheels provide increased manoeuvrability over various surfaces

Available in blue or red

Easy wipe-clean surfaces



### SEAT WALKER XL

Rustproof, robust aluminium frame for durability and stability, very light to manoeuvre and transport

Wide padded seat and increased 180kg safe working load for large users

Handle height adjusts quickly with hand wheels for optimal sizing

Anatomically designed, latex-free handles allow comfortable grip especially for users with arthritis

Ultra-soft hand brakes with palm ball lock effortlessly, offering increased comfort for users with arthritis or wrist/hand joint pain

Extra large padded seat flips up easily for access to storage bag (supplied) or for folding

Curved and padded backrest flips up/removes easily for folding/storage

Easy folding mechanism facilitates storage and transportation

Swivelling front castor wheels increase manoeuvrability

8" solid, puncture-proof wheels provide increased manoeuvrability over various surfaces

Available in silver

Easy wipe-clean surfaces



### SEAT WALKER TRI-WHEEL

Rustproof, robust aluminium frame for durability and stability, very light to manoeuvre and transport

Handle height adjusts to suit user requirements

Three-wheel ideal of using in confined spaces

Ultra-soft handbrakes with palm ball lock effortlessly, offering increased comfort for users with arthritis or wrist / hand joint pain

Easy folding mechanism facilitates storage and transportation

Handbrakes are lockable for stability while standing

Strong heavy gauge steel constructions for support and durability

Basket, bag and meal tray provided for storage and ease of travel

Swivelling front castor wheels increase manoeuvrability

Available in red

Easy wipe-clean surfaces



### SEAT WALKER FLEX 6" & 8"

Rustproof, robust aluminium frame for durability and stability, very light to manoeuvre and easy to transport

Adjustable walker height

Adjustable handle height

Lockable handbrakes for stability while standing

Folding mechanism for easy transport and storage

Removable under-seat storage bag

Easy wipe clean

Available in black (6") and champagne (8")

## 8. INSTRUCTIONS FOR USE

### APPLYING BRAKES

FOR MODELS WITH HAND BRAKE ONLY

Aspire Seat Walkers feature ultra soft touch brakes - very little force is required to engage the brake lock. Always use the seat walker handles, not brake levers, to support body weight. Ultra soft touch brake levers are not designed for this purpose which may cause damage.

1. Pull the hand brake up towards the palm of your hand creating a fist



- 2a. Push the hand brake down gently until lock activates.  
This can be done with as little as 2.5kg of pressure

- 2b. To release the brake, push the hand piece back towards the grip



**WARNING:** The rollator must not be driven or pushed with force when the parking brakes are on or when the wheels are partly locked using the brakes. This indicates incorrect use and can cause wear and tear, impairing tyres, and brake quality.

### SITTING ON THE WALKING FRAME

FOR MODELS WITH HAND BRAKES ONLY

1. Ensure the hand brakes have been pushed down until an audible click noise has been heard. This function can also be confirmed visually as the brake handle will remain pushed down (image 2a on previous page)
2. While holding on to the handles (not the brake levers) turn with your back facing the seat and pull the seat walker towards you until it can be felt against the back of your legs
3. Slowly and carefully lower yourself on to the seat
4. **Always** sit centrally on the seat walker, avoid leaning heavily to either side as this may cause the seat walker to become unstable
5. **NEVER** propel yourself with your feet using the seat walker as a transportation device – it is **NOT** designed for this purpose.
6. **NEVER** allow another person to push you along in the seat walker whilst seated as it is **NOT** designed as a transportation device or to serve as a substitute for a wheelchair

FOR TRI-WHEEL MODELS



This model of walker is **NOT** designed for seating, as its only purpose is to assist user mobility

## CORRECT SEATING GUIDE



WARNING

**WARNING:** The Backrest is intended to provide back support while seated. The Backrest is **NOT** intended to support full body weight.



**DO NOT** sit on backrest.



**DO NOT** reach into bag while seated.

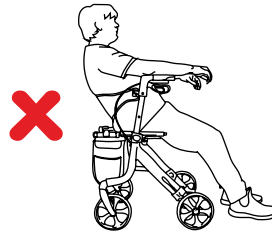

**DO NOT** slouch on backrest.

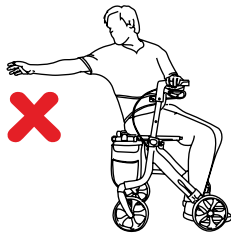

**DO NOT** reach behind while seated.

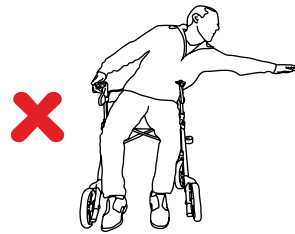

**DO NOT** reach sideways while seated.



WARNING

**WARNING!** Avoid reaching from within the walker. To ensure the upright stability of the walker, never reach for objects as this changes the centre of mass and may cause the walker to tip over in the direction of reaching. This warning relates to reaching in any direction outside the perimeter of the walker.

## FOLDING AND STORAGE

1. Lift up the padded seat
2. Pull on the handle in the under seat bag, this will cause the A-Frame section to fold
3. Pull up the padded backrest – or alternatively this can be removed using the push buttons on either end of the backrest



WARNING

**WARNING!** After unfolding or assembling the walker always ensure that the seat is securely locked and the frame does not move anymore.



WARNING

**WARNING!** Failure to follow these warnings can result in personal injury. Ensure that the seat is securely locked and the frame does not move anymore.



## BRAKE ADJUSTMENT

1. A tension adjustment nut is located at the point where the brake cable inserts into the brake handle (refer to image 1). There is also a tension adjustment at the other end of the brake cable where it inserts into the brake mechanism near the rear wheel (refer to image 2)

These adjustment nuts can be used to tighten the cable (if brakes are loose or not working normally) or loosen if brakes are too tight and not allowing the rear wheels to roll freely

2. Brakes are adjusted to the optimal tension during manufacturing and should not require adjustment when new. Over time as rear wheels wear and reduce in diameter, brakes can and will become loose and may need to be tightened



## ADJUSTING HANDLE HEIGHT

1. Undo hand wheel
2. Reposition handle to appropriate height
3. Reinsert hand wheel and tighten



FOR XL MODEL:

1. Undo hand wheel from nut and reposition handle to appropriate height
2. Reinsert hand wheel, add washer and nut then tighten

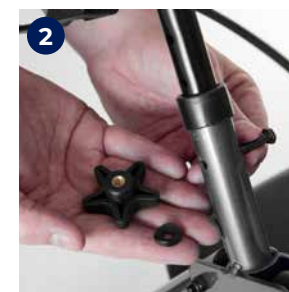
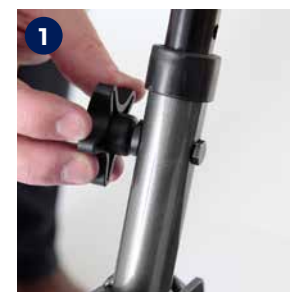

WARNING

**WARNING!** You should always engage the brakes when you don't want the walker to move.



WARNING

**WARNING!** NEVER leave the walker without the brakes engaged when there is someone sitting in it.



WARNING

**WARNING!** NEVER leave the walker on a slope without the brakes engaged.



WARNING

**WARNING!** The rollator must not be driven or pushed with force when the parking brakes are on or when the wheels are partly locked using the brakes. This indicates incorrect use and can cause wear and tear, impairing tyres, and brake quality.

## WALKER SETUP (FLEX 6 & 8 ONLY)

### BOX CONTAINS

- Walker frame x 1
- Rear wheels x 2
- Handles with Brakes x 2
- Front Wheels x 2
- Backrest x 1
- Hand wheel bolts for legs x 4
- Hand wheel bolts for arms x 2

### HANDLE ASSEMBLY

1. Insert the brake handle tube into the walker frame, ensuring that the brake angles outwards to ensure the left and right handles are on the correct side.
2. Tighten in place with hand wheel bolts, on both sides.
3. Handle assembly is now complete.

**Note:** Ensure handle height is the same on either side of the walker.

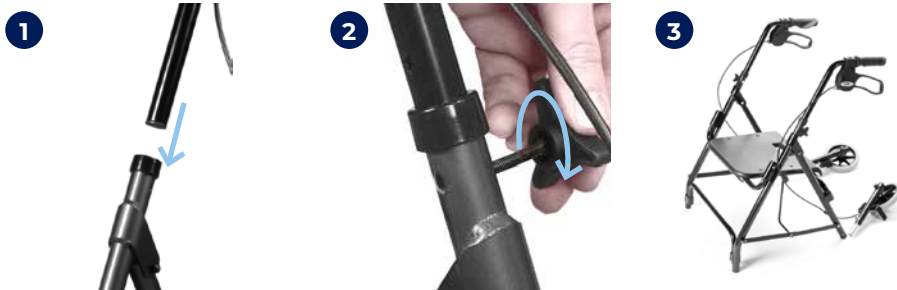

### FRONT AND REAR WHEEL ASSEMBLY

1. Insert rear wheel tubes into the walker frame, ensuring the wheel is on the outside of the tube. Tighten in place with hand wheel bolts.
2. Insert front wheel tubes into the walker frame, ensuring the brake cable is in line with the same side of the walker. Tighten in place with hand wheel bolts.
3. Wheel assembly is now complete.

**Note:** Ensure wheel height is the same on all four wheels of the walker.



### BACKREST BAR ASSEMBLY

1. Insert backrest into receivers. Once a notable 'click' sound is heard, the backrest is now secured.

**Note:** Ensure backrest is locked in place on both sides of the walker before use.



## 9. CARE, MAINTENANCE & CUSTOMISATION

---

### MAINTENANCE SCHEDULE

#### Weekly

- Check brakes for malfunction
- Check all wheels, castors and hinge points for loose bolts and nuts

#### Periodically

- Check handgrips for wear
- Check frame bolts are secure
- Check folding hinge bolts are secure
- Check front and rear axle bolts are secure
- Check for wear or cracks
- Check wheels for splitting or damage
- Check seat upholstery for wear and seat base for cracks and that it is secured to frame

#### Yearly

- Once a year take your seat walker to an authorised repairer for a full check, clean, service and lubrication of all moving parts

#### Serviceable Components

- Wheels
- Brake Cables
- Bearings
- Bag
- Seat
- Bolts and Nuts
- Hand grips
- Brake Handles

### CUSTOMISATION

All walker customisation, Modification and or alterations made to this product are considered as “custom” changes. They may cause the product to no longer meet safety standards and should be considered prior to commencement. Any customisation or modification of the walker is not warranted by Aidacare and will void the warranty.

## 10. COMPLIANCE

---

Aspire walkers are manufactured and independently tested to the market-relevant compliance standards.

Labels on the wheelchair address compliance requirements and users should familiarise themselves with these prior to use.

## 11. WARRANTY

---

This product comes with a warranty of 12 months. Consumable parts (brake pads, castors, and upholstery) carry a 1-year warranty against manufacturer defect only and do not cover wear and tear through use.

**If you have any questions, you can contact:**



**Manufacturer:**  
**Aidacare Pty Ltd**

ABN 40 134 833

Building 3A, 1 Moorebank Avenue,  
Moorebank NSW 2170

**1300 133 120** | [product@aidacare.com.au](mailto:product@aidacare.com.au)

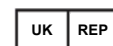

**UK Representative:**  
**European Device Solutions Ltd**

15 Coanwood Drive, Whitley Bay  
Tyne and Wear NE25 9GB

[info@europeandevicesolutions.co.uk](mailto:info@europeandevicesolutions.co.uk)



**Importer:**  
**Aidacare Limited.**

Registration 13785408

Arcadia House, Maritime Walk, Ocean Village,  
Southampton SO14 3TL

**01622 541235** | [info@aidacare.co.uk](mailto:info@aidacare.co.uk)

## 12. SERVICE LOG BOOK

---

<b>Year 1</b>	Date: _____
Service Type: _____	
Condition Report: _____	
Inspected by: _____	Signature: _____
Action taken: _____	Date: _____

<b>Year 2</b>	Date: _____
Service Type: _____	
Condition Report: _____	
Inspected by: _____	Signature: _____
Action taken: _____	Date: _____

<b>Year 3</b>	Date: _____
Service Type: _____	
Condition Report: _____	
Inspected by: _____	Signature: _____
Action taken: _____	Date: _____

<b>Year 4</b>	Date: _____
Service Type: _____	
Condition Report: _____	
Inspected by: _____	Signature: _____
Action taken: _____	Date: _____

## **AIDACARE PTY LTD**

Building 3A, 1 Moorebank Avenue,  
Moorebank NSW 2170 Australia

**1300 133 120** | [aidacare.com.au](http://aidacare.com.au)

## **AIDACARE LIMITED**

Arcadia House, Maritime Walk,  
Ocean Village, Southampton SO14 3TL  
United Kingdom

**01622 541235** | [aidacare.co.uk](http://aidacare.co.uk)

MADE IN PRC